

ARTICULATION BOOM LIFT

SPECIFICATIONS

MODELS	AR20J-2 (AR65J-2)	
Measurements	Metric	Imperial
Work Height Max.	21.58m	70'10"
Platform Height Max.	19.58m	64'3"
Horizontal Outreach	11.87m	38'11"
Up and Over Height	8.19m	26'10"
Platform Length	2.44m	8'
Platform Width	0.9m	2'11"
Ⓐ Stowed Length	9.42m	30'11"
Transport Length (jib tucked)	7.63m	25'
Ⓑ Overall Width	2.5m	8'2"
Ⓒ Stowed Height	2.46m	8'1"
Transport Height	2.96m	9'9"
Ⓓ Wheelbase	2.51m	8'3"
Ⓔ Ground Clearance	0.4m	1'4"

PRODUCTIVITY		
Platform Capacity (unrestricted)	260kg	573 lbs
Platform Capacity (restricted)	350kg	772 lbs
Max. Platform Occupancy	2(unrestricted)/3(restricted)	
Turntable Rotation	360°	360°
Drive Speed-Stowed	5km/h	3.1mph
Drive Speed-Raised	0.8km/h	0.5mph
Gradeability	45%	45%
Max. Wind Speed	12.5m/s	28mph
Turning Radius-Inside	3.5m	11'6"
Turning Radius-Outside	6.35m	20'10"
Max. Slope	4°/4°	4°/4°
Tire Type	Solid	
Tire Models	36×14-20	
Ground Pressure, Tyres	530.7 kPa	77 psi

POWER		
Power Source	Kubota 36kW/48.3hp	
Fuel Tank Capacity	60L	15.9gal

HYDRAULIC SYSTEM		
Hydraulic Oil Volume	95L	25.1gal

WEIGHT		
Machine Weight	9,300kg	20,503 lbs

STANDARD FEATURES

Auto-leveling platform
Hydraulic rotating platform 180°
Full proportional joystick control
Descent alarm
Flashing beacons
Horn/Hour meter
Over-tilt protection system
Emergency stop button
Intelligent self-diagnosis function
Cylinder bellows
OTA remote upgrade
Dustproof components
Over-head anti-collision protection
Platform tool box

OPTIONAL

AC power to platform
Platform work light
Half-height mesh platform
Platform auxiliary guardrail
Platform storage rack

MACHINE SIZE

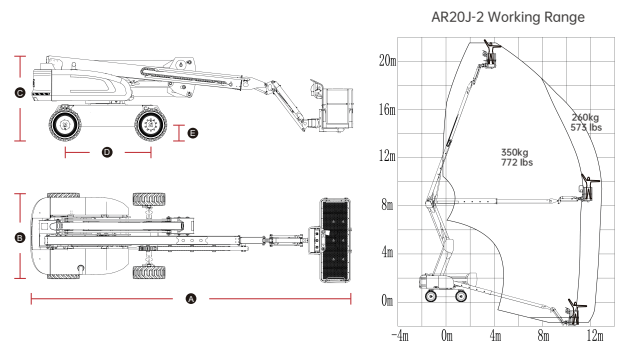

Please contact LGMG or a local dealer for more details.

LGMG reserves the right to change technical data without prior notice. All photos and pictures in this brochure are for promotional purposes only.